

Service Bulletin

MOTORCYCLE DIVISION

4-STROKE
BULLETIN GS/GSX/GSX-R NO. 199
DATE: 4/6/2009

SUBJECT: ABNORMAL CLUTCH NOISE

AFFECTED UNITS: ALL GSX1300RK8, ALL GSX1300BKK8, AND
CERTAIN GSX1300RK9 MODELS (See Affected Units on Page 2)

REFERENCE: GSX1300R SERVICE MANUAL (P/N 99500-39350-03E)
GSX1300BK SERVICE MANUAL (P/N 99500-39321-03E)

Suzuki has received field reports of a light metallic "ticking" noise coming from the clutch cover area on the right side of GSX1300RK8-K9 and GSX1300BKK8 model motorcycles. The noise is most distinguishable when the engine is running at idle speed. The noise occurs when a clutch spring support bolt ① loosens from the clutch cam ② and allows the head of a clutch spring bolt to come in contact with the clutch cover during engine operation. Typically, when found on retail units this condition occurs at lower mileages.

Suzuki requires that the following procedure be completed on:

- All new units prior to retail delivery
- Retail units exhibiting the noise described above.

Clean the threads of the clutch spring support bolts ① and clutch cam ②. Apply thread lock to the clutch spring support bolts and tighten them to the specified torque. Install the clutch cover using a new gasket and tighten the cover bolts to the specified torque.

 : Thread lock cement 99000-32030
(Thread Lock Cement Super 1303 or equivalent)

 Clutch Spring Support Bolts 23 N·m
(2.3 kgf-m, 16.5 lb-ft)

 Clutch Spring Bolts 10 N·m (1.0 kgf-m,
7.0 lb-ft)

 Clutch Cover Bolts 10 N·m (1.0 kgf-m,
7.0 lb-ft)

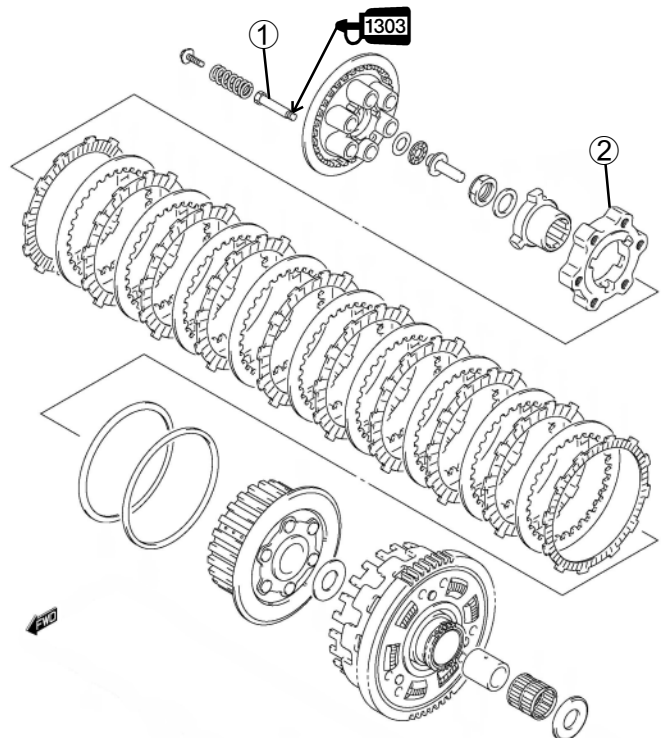

Affected Units

Model	Specification	Range
GSX1300RK8	ALL	ALL
GSX1300BKK8	ALL	ALL
GSX1300RK9	E-03	JS1GX72A *92102653 and before
GSX1300RK9	E-33	JS1GX72A *92104270 and before

Warranty Information

Warranty claims will be accepted for new units and retail units within the original warranty period. Use the following information to submit a regular warranty claim:

Causal Part 21481-24F30

Complaint Code 26

Defect Code 48

Labor Operation GA9999

Labor Time 1.0 hrs

AFFECTED DEPARTMENTS:

The following departments in your dealership should be notified of this information:

☒ **Management** ☒ **Service** ☒ **Warranty** ☐ Sales ☐ Parts ☐ Accessories

American Suzuki Motor Corporation
Technical Service Department
Motorcycle / ATV / Scooter